

NEW

from

HAKKO®

FM-2030

HEAVY DUTY SOLDERING IRON

The FM-2030 Heavy Duty Soldering Iron provides a higher mass tip with double the power of conventional Hakko T15 tips, making this iron the ideal solution for difficult-to-solder applications, such as heavy ground planes and high heat sink applications. Uses T22 tips (not included)

Part Number: FM2030-01

Note:

FM-203 stations with serial numbers before 0220311002129 will require the purchase of an upgrade. Contact American Hakko for more information.



P/N: FM2030-02

FM-203

DUAL PORT SOLDERING STATION



USE WITH

FM-206

3-PORT REWORK STATION



The FM-2030 soldering iron can only be attached to the FM-203 "D" Port and the FM-206 CH2 or CH3 ports



HakkoUSA.com

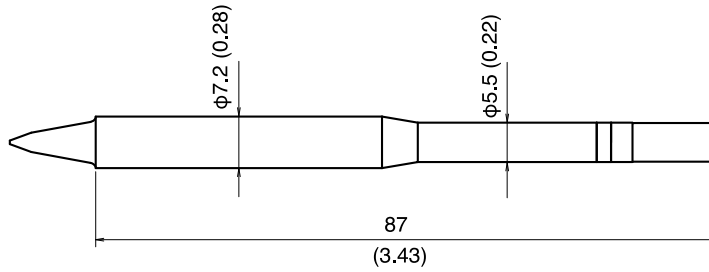

Unit : mm (in.)

T22-BL SHAPE-BL

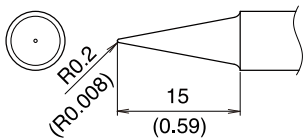

T22-BL2 SHAPE-2BL

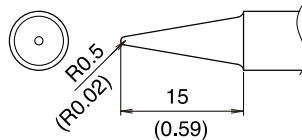

T22-BC2 SHAPE-2BC

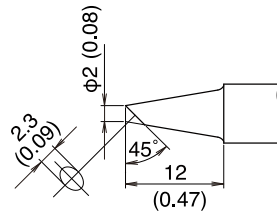

T22-C3 SHAPE-3C

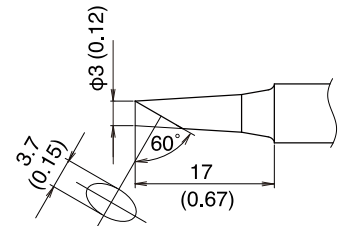

T22-C5 SHAPE-5C

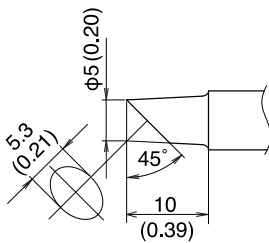

T22-C6 SHAPE-6C

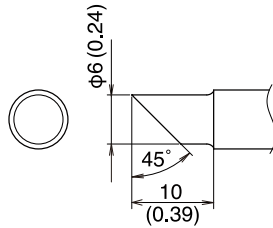

T22-D08 SHAPE-0.8D

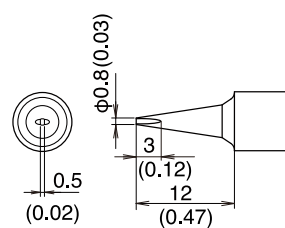

T22-D12 SHAPE-1.2D

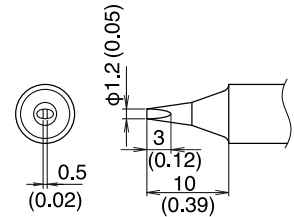

T22-D16 SHAPE-1.6D

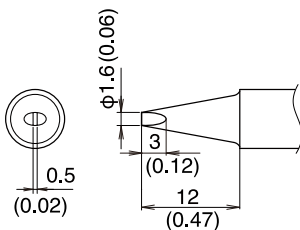

T22-D24 SHAPE-2.4D

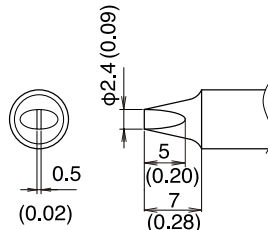

T22-D32 SHAPE-3.2D

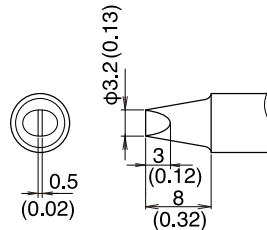

T22-D45 SHAPE-4.5D

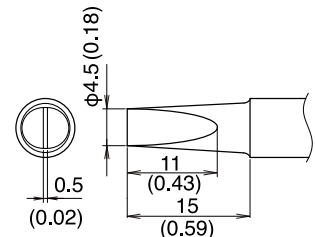

T22-D52 SHAPE-5.2D

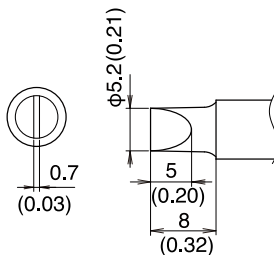

T22-J02 SHAPE-0.2J

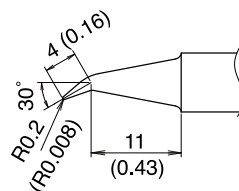

T22-JD08 SHAPE-0.8JD

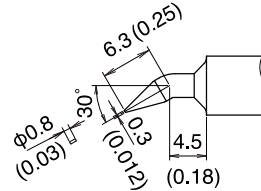

T22-K SHAPE-K

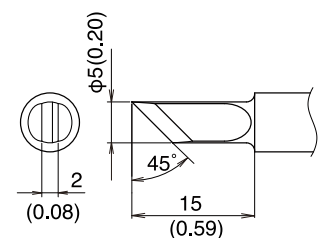

Distributed by:
All-Spec Industries
Wilmington, NC

Ph: 800-537-0351
Fx: 800-379-9903

Web: www.all-spec.com
Email: sales@all-spec.com

American Hakko Products, Inc. • 28920 Ave. Williams • Valencia, CA 91355
Tel: 661.294.0090 • Fax: 661.294.0096 • www.HakkoUSA.com